

# Installation Instructions

**GBE17HYRFS**

If you have questions, call **1.800.GE.CARES** or visit our Website at: **GEAppliances.com**.  
 In Canada, call 1.800.561.3344 or Visit our Website at: **geappliances.ca**

## BEFORE YOU BEGIN

Read these instructions completely and carefully.

- **IMPORTANT** – Save these instructions for local inspector’s use.
- **IMPORTANT** – Observe all governing codes and ordinances.
- **Note to Installer** – Be sure to leave these instructions with the Consumer.
- **Note to Consumer** – Keep these instructions for future reference.
- **Skill level** – Installation of this appliance requires basic mechanical skills.
- **Completion time**– Refrigerator Installation  
15 minutes  
Reversing the Door Swing  
15 minutes
- Proper installation is the responsibility of the installer.
- Product failure due to improper installation is not covered under the Warranty.

## CLEARANCES

Allow the following clearances for ease of installation, proper air circulation and plumbing and electrical connections.

- Sides 3/4" (19 mm)
- Top 1" (25 mm)
- Back 2" (50.8 mm)

## REFRIGERATOR LOCATION

- Do not install the refrigerator where the temperature will go below 55°F (12.7°C) because it will not run often enough to maintain proper temperatures.
- Do not install the refrigerator where the temperature will go above 100°F (37°C) because it will not perform properly.
- Do not install the refrigerator in a location exposed to water (rain, etc.) or direct sunlight.
- Install it on a floor strong enough to support it fully loaded.

## ROLLERS AND LEVELING LEGS

**Leveling legs** near each front corner of the refrigerator are adjustable. They firmly position the refrigerator and prevent it from moving when the doors are opened. Leveling legs should be set so the front of the refrigerator is raised just enough that the doors close easily when opened about halfway.

Turn the leveling legs **clockwise to raise** the refrigerator, **counterclockwise to lower** it.

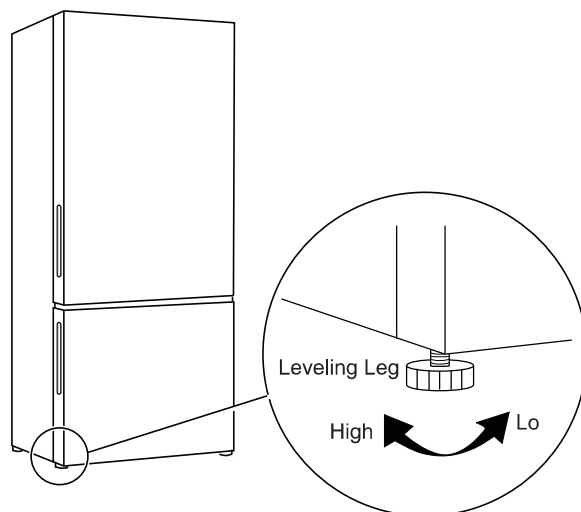

## REVERSE DOOR SWING

The door swing on this refrigerator can be reversed from right to left. For detail installation, please download the Owner’s Manual from website and follow the instruction in the manual.

# Installation Instructions

## REVERSING THE DOOR SWING

**⚠ WARNING** Follow all steps when reversing the door swing. Failure to follow these instructions, leaving off parts, or overtightening screws, can lead to the door falling off and result in injury and property damage.

### IMPORTANT NOTES

When reversing the door swing:

- Read the instructions all the way through before starting.
- Tighten all hinge screws but avoid over-tightening to prevent stripping.
- Handle parts carefully to avoid scratching paint.
- Set screws down by their related parts to avoid losing them.
- Provide a non-scratching work surface for the doors.

### ⚠ CAUTION

- **Lifting Hazard** The Refrigerator and Freezer doors are heavy. Use both hands to secure the doors before lifting.
- Unplug the refrigerator from its electrical outlet.
- Do not tilt the appliance more than 45° to prevent damage of the cooling system.

### TOOLS REQUIRED



Phillips screwdriver

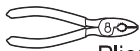

Pliers



Flat head screwdriver

1. Locate the necessary tools and unplug the appliance.

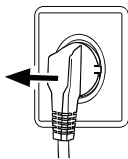

#### Refrigerator Door (Upper)

2. Remove the cover on the left side of the faceplate.

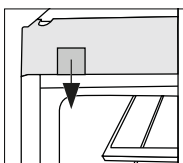

3. Remove the faceplate on the unit.

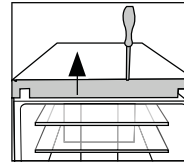

4. Remove the top plate at the top of the door.

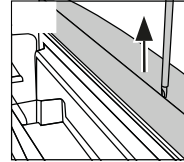

5. Remove the hinge cover.

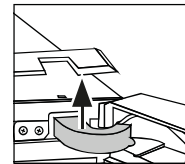

6. Unplug the connector cable.

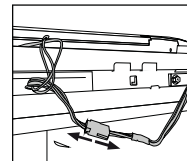

7. Unscrew the upper hinge.

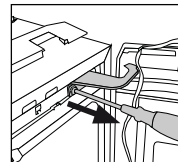

8. Lift the upper door carefully off of the lower hinge.

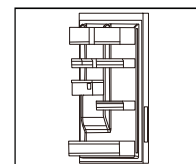

9. Turn the upper door upside down and change the door stop from the current position to the opposite side.

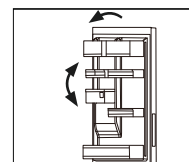
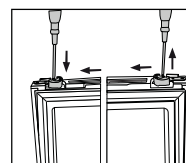

# Installation Instructions

## REVERSING THE DOOR SWING (CONT.)

**⚠ WARNING** Follow all steps when reversing the door swing. Failure to follow these instructions, leaving off parts, or overtightening screws, can lead to the door falling off and result in injury and property damage.

10. Unscrew the lower hinge from the case.
11. Change the position of the plugs on the case from one side to the other.

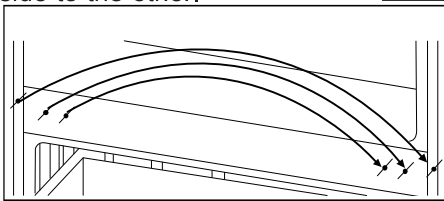
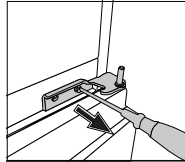

### Freezer Door (Lower)

12. Remove the Freezer (Lower) Door.
13. Change the door stop at the bottom of the door from the current position to the opposite side.

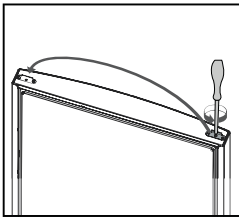
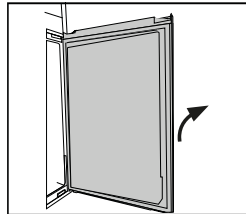

14. Unscrew the bottom hinge. Change the bottom foot from the current position to opposite side.

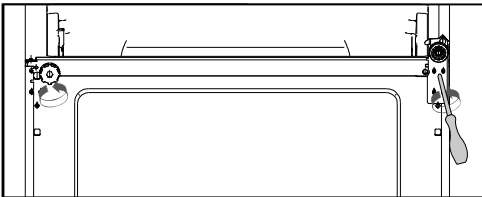

15. Take out the new bottom hinge from the accessory bag and screw the new bottom hinge to the other side of the door opening on the case.

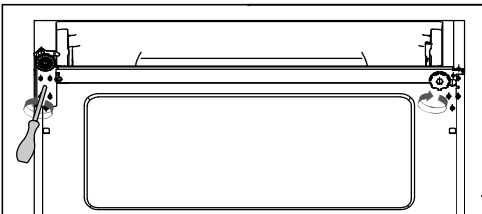

16. Lift the lower door, carefully, onto the bottom hinge so that the pivot fits into the hinge barrel.

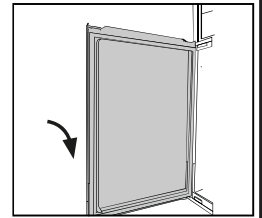

17. Take out the new hinge from the accessory bag and screw the new middle hinge for the upper door to the other side of the door opening. **Be sure to seat the hinge pivot into the hinge barrel of the lower door.**

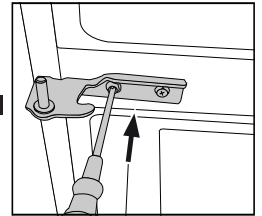

### Refrigerator Door (Upper)

18. Lift the door, carefully, onto the middle hinge so that the pivot fits in to the hinge barrel.
19. Attach the upper hinge with the screws.

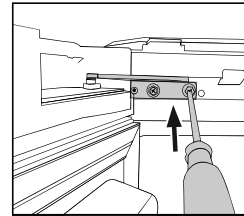
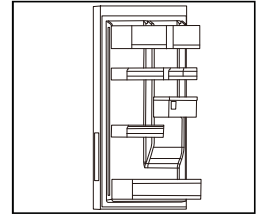

20. Place the connector cable, from the accessory bag, through the hinge cover and over the hinge.
21. Plug in the connector cable and fit it into the opening.

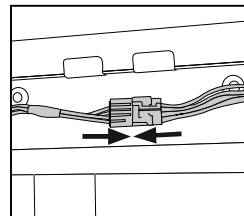
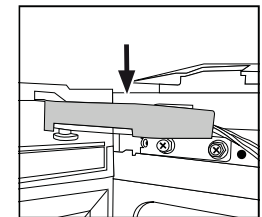

22. Replace faceplate and attach it with the screws. Reinstall the cover from the faceplate.

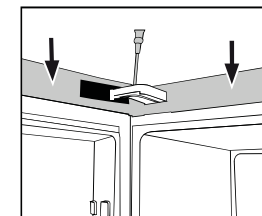

Check that the door seals are all secured properly and all screws are tightened.

# Normal Operating Sounds

Newer refrigerators sound different from older refrigerators. Modern refrigerators have more features and use newer technology.

## Do you hear what I hear? These sounds are normal.

- The new high efficiency compressor may run faster and longer than your old refrigerator and you may hear a high-pitched hum or pulsating sound while it is operating.
- You may hear a whooshing sound when the doors close. This is due to pressure equalizing within the refrigerator.

**HUMMM...**  
**WHOOSH...**



- You may hear the fans spinning at high speeds. This happens when the refrigerator is first plugged in, when the doors are opened frequently or when a large amount of food is added to the refrigerator or freezer compartments. The fans are helping to maintain the correct temperatures.

## CLICKS, POPS, CRACKS and CHIRPS

- You may hear cracking or popping sounds when the refrigerator is first plugged in. This happens as the refrigerator cools to the correct temperature.
- The compressor may cause a clicking or chirping sound when attempting to restart (this could take up to 5 minutes).
- Expansion and contraction of cooling coils during and after defrost can cause a cracking or popping sound.



## WATER SOUNDS

- The flow of refrigerant through the freezer cooling coils may make a gurgling noise like boiling water.
- Water dropping on the defrost heater can cause a sizzling, popping or buzzing sound during the defrost cycle.
- A water dripping noise may occur during the defrost cycle as ice melts from the evaporator and flows into the drain pan.
- Closing the door may cause a gurgling sound due to pressure equalization.

## Troubleshooting Tips... Before you call for service

Save time and money! Review the charts on the following pages first and you may not need to call for service. If needed, service can be scheduled by visiting us online **GEAppliances.com** or calling 800.GECARES 800.432.2737. In Canada visit **GEAppliances.ca** or call 800.561.3344.

<b>Problem</b>	<b>Possible Causes</b>	<b>What to Do</b>
It is not cold enough inside the appliance.	The temperature is set too high.	Wait about 30 minutes for defrost cycle to end.
	The temperature of the food stored is too warm.	Always cool down goods before storing them.
	Too much food has been stored at one time.	Always store small quantities of food at a time.
	The goods are too close to each other.	Leave a gap between several foods allowing air flow.
	A door of the appliance is not tightly closed.	Close the door.
	A door has been opened too frequently or for too long.	Do not open the door too frequently.
It is too cold inside the appliance.	The temperature is set too low.	Reset the temperature.
	The Turbo Freeze/Turbo Cool function is activated or is running too long.	Switch off the Turbo Freeze/Turbo Cool function.
Moisture formation on the inside of the refrigerator compartment.	The climate is too warm and too damp.	Increase the temperature.
	A door of the appliance is not tightly closed.	Close the door.
	The door has been opened too frequently or for too long.	Do not open the door too frequently.
	Food containers or liquids are left open.	Let hot foods cool to room temperature and cover foods and liquids.
Moisture accumulates on the refrigerator outside surface or between the doors/door and drawer.	The climate is too warm and too damp.	This is normal in damp climate and will change when the humidity decreases.
	The door is not closed tightly. The cold air in the appliance and the warm air outside it condensates.	Ensure that the door is tightly shut.
Strong ice and frost in the freezer compartment.	The goods were not adequately packaged.	Always pack the goods well.
	A door of the appliance is not tightly closed.	Close the door.
	The door has been opened too frequently or for too long.	Do not open the door too frequently.
	The door gasket is dirty, worn, cracked or mismatched.	Clean the door gasket or replace them with new ones.
	Something on the inside prevents the door/drawer to close properly.	Reposition the shelves, door racks, or internal containers to allow the door to close.
The appliance makes abnormal sounds.	The appliance is not located on level ground.	Adjust the feet to level the appliance.
	The appliance touches some object around it.	Remove objects around the appliance.
A slight sound is heard similar to that of flowing water.		This is normal.
You hear an alarm beep.	The fridge storage compartment door is open.	Close the door or silence the alarm manually.
	The temperature in the freezer is too high.	The alarm is normal when it is first started due to relatively higher temperature. You can silence the alarm manually.
You hear a faint hum.	The anti-condensation system is working.	This prevents condensation and is normal.
The interior lighting or cooling system does not work.	Mains plug is not connected in the main socket.	Connect the mains plug.
	The power supply is not intact.	Check the electrical supply to the room. Call the local electricity company!
	The LED lamp is out of order.	Please call customer service to change the lamp.

# Refrigerator Limited Warranty

**For US Customers**, all warranty service provided by our Factory Service Centers, or an authorized Customer Care® technician. To schedule service, on-line, 24 hours a day, visit us at **GEAppliances.com**, or call 800.GE.CARES (800.432.2737). Please have serial number and model number available when calling for service.

**In Canada**, call 800.561.3344.

For the Period of:	GE Appliances Will Replace
<b>One Year</b> From the date of the original purchase	<b>Any part</b> of the refrigerator which fails due to a defect in materials or workmanship. During the <b>limited one-year warranty</b> , GE Appliances will also provide, <b>free of charge</b> , all labor and related service to replace the defective part.

## What is Not Covered:

- Service trips to your home to teach you how to use the product.
- Improper installation, delivery or maintenance.
- Failure of the product if it is abused, misused, or used for other than the intended purpose or used commercially.
- Loss of food due to spoilage.
- Replacement of house fuses or resetting of circuit breakers.
- Damage caused after delivery.
- Replacement of the water filter cartridge, if included, due to water pressure that is outside the specified operating range or due to excessive sediment in the water supply.
- Replacement of the light bulbs, if included, or water filter cartridge, if included, other than as noted above.
- Damage to the product caused by accident, fire, floods or acts of God.
- Incidental or consequential damage caused by possible defects with this appliance.
- Product not accessible to provide required service.
- Damage caused by a non-GE Appliances Brand water filter.
- Damage to finish, such as surface rust, tarnish, or small blemishes not reported within 48 hours of delivery.
- Products which are not defective, broken, or which are working as described in the owner's manual.

**EXCLUSION OF IMPLIED WARRANTIES—Your sole and exclusive remedy is product repair as provided in this Limited Warranty. Any implied warranties, including the implied warranties of merchantability or fitness for a particular purpose, are limited to one year or the shortest period allowed by law.**

Staple your receipt here. Proof of the original purchase date is needed to obtain service under the warranty.

**For US Customers:** This limited warranty is extended to the original purchaser and any succeeding owner for products purchased for home use within the USA. If the product is located in an area where service by a GE Appliances Authorized Servicer is not available, you may be responsible for a trip charge or you may be required to bring the product to an Authorized GE Appliances Service location for service. In Alaska, the limited warranty excludes the cost of shipping or service calls to your home.

Some states do not allow the exclusion or limitation of incidental or consequential damages. This limited warranty gives you specific legal rights, and you may also have other rights which vary from state to state. To know what your legal rights are, consult your local or state consumer affairs office or your state's Attorney General.

**Warrantor US: GE Appliances, a Haier company**  
**Louisville, KY 40225**

**For Customers in Canada:** This limited warranty is extended to the original purchaser and any succeeding owner for products purchased in Canada for home use within Canada. In-home warrant service will be provided in areas where it is available and deemed reasonable by Mabe to provide.

**Warrantor Canada: MC Commercial, Burlington, Ontario, L7R 5B6**



# Consumer Support

---

## GE Appliances Website

Have a question or need assistance with your appliance? Try the GE Appliances Website 24 hours a day, any day of the year! You can also shop for more great GE Appliances products and take advantage of all our on-line support services designed for your convenience. In the US: [GEAppliances.com](http://GEAppliances.com) In Canada: [GEAppliances.ca](http://GEAppliances.ca)

---

## Register Your Appliance

Register your new appliance on-line at your convenience! Timely product registration will allow for enhanced communication and prompt service under the terms of your warranty, should the need arise. You may also mail in the pre-printed registration card included in the packing material.

In the US: [GEAppliances.com/register](http://GEAppliances.com/register)

In the Canada: [Prodsupport.mabe.ca/crm/Products/ProductRegistration.aspx](http://Prodsupport.mabe.ca/crm/Products/ProductRegistration.aspx)

---

## Schedule Service

Expert GE Appliances repair service is only one step away from your door. Get on-line and schedule your service at your convenience any day of the year. In the US: [GEAppliances.com/service](http://GEAppliances.com/service) or call 800.432.2737 during normal business hours.

In Canada: [GEAppliances.ca/en/support/service-request](http://GEAppliances.ca/en/support/service-request) or call 800.561.3344

---

## Extended Warranties

Purchase a GE Appliances extended warranty and learn about special discounts that are available while your warranty is still in effect. You can purchase it on-line anytime. GE Appliances Services will still be there after your warranty expires.

In the US: [GEAppliances.com/extended-warranty](http://GEAppliances.com/extended-warranty) or call 800.626.2224 during normal business hours.

In Canada: [GEAppliances.ca/en/support/purchase-extended-warranty](http://GEAppliances.ca/en/support/purchase-extended-warranty) or call 800.290.9029

---

## Remote Connectivity

For assistance with wireless network connectivity (for models with remote enable), visit our website at [GEAppliances.com/connect](http://GEAppliances.com/connect) or call 800.220.6899.

In Canada: [GEAppliances.ca/connected-home-smart-appliances/](http://GEAppliances.ca/connected-home-smart-appliances/) or call 800.220.6899.

---

## Parts and Accessories

Individuals qualified to service their own appliances can have parts or accessories sent directly to their homes (VISA, MasterCard and Discover cards are accepted). Order on-line today 24 hours every day.

In the US: [GEApplianceparts.com](http://GEApplianceparts.com) or by phone at 877.959.8688 during normal business hours.

**Instructions contained in this manual cover procedures to be performed by any user. Other servicing generally should be referred to qualified service personnel. Caution must be exercised, since improper servicing may cause unsafe operation.**

Customers in Canada should consult the yellow pages for the nearest Mabe service center, visit our website at [GEAppliances.ca/en/products/parts-filters-accessories](http://GEAppliances.ca/en/products/parts-filters-accessories) or call 800.661.1616.

---

## Contact Us

If you are not satisfied with the service you receive from GE Appliances, contact us on our Website with all the details including your phone number, or write to:

In the US: General Manager, Customer Relations | GE Appliances, Appliance Park | Louisville, KY 40225

[GEAppliances.com/contact](http://GEAppliances.com/contact)

In Canada: Director, Consumer Relations, Mabe Canada Inc. | Suite 310, 1 Factory Lane | Moncton, N.B. E1C 9M3

[GEAppliances.ca/en/contact-us](http://GEAppliances.ca/en/contact-us)

---